



I-75 Exit 293 at Hwy 411, 30 miles north of Atlanta
Physical Address: 100 Tellus Drive, White, GA 30184
Mailing Address: P.O. Box 3663, Cartersville, GA 30120
Central Scheduling: 770-606-5699

Dear Educator:

Thank you for choosing Tellus Science Museum as an extension of your science instruction! Please review the following information carefully and share with the other teachers on your team so that everyone involved will have the best experience possible.

Payment Policy

We expect payment, less the deposit, at the time you check in. Please bring check, cash, or credit card on arrival or your group will not be admitted. We accept checks made payable to Tellus Science Museum, as well as Visa, Master Card, Discover, and American Express.

- **Please, be sure to share all of this information with all participating teachers and responsible parties. We can not be responsible if a teacher was not informed of our payment policy and other instructions.**
- **If your group is attending multiple days bring payment each day or pre-pay for all groups ahead of time.**
- **You may pay for extra parents and chaperones or they may pay individually.**
- **We require that one person check in and pay for the entire group and must use one form of payment, with the exception of extra parents, as stated above.**
- **All programs are scheduled for a minimum of fifteen paying students. If your number drops below fifteen, you will be required to pay for 15 students.**
- **On the day of your program count your students, educators & parents that you are paying for, and bring that number to the front desk at check in. Once your order is completed there will be no refunds.**

Programs

- Each program involves four rotations which include: a lab, an activity, an in-depth exploration of one gallery, and a stop in our museum store. Please see Program Descriptions for more details.
- A stop in our museum store, with additional instructional time, is a part of our programs and a significant life skill opportunity for students.
- Program length is 1½ to 2 hours depending on grade levels.
- Programs are based on Georgia Performance Standards for Science.

Check In

- Please have accurate attendance numbers for your students, educators and parents that the school is paying for, when checking in.
- Your program manager will contact you approximately one week before your visit to advise you on how to split your group into subgroups and to give you other details for your check-in.
- Every individual (student, parent, educators) needs a program sticker before leaving the lobby.

Student minimum

- Minimum of 15 students.
- If you have less than 15 students in your group you will be required to pay for 15 students. Adults do not count toward this number.

Student maximum

- Maximum of 90 students for all Pre-K & Kindergarten programs.
- Maximum of 120 students for all other grades.
- Science in Motion programs include the planetarium, which seats only 120. Please plan accordingly. Students have first priority for seating, then educators, then parents.

Times

- Please be at the museum 30 minutes prior to your program's scheduled start time to check in and to afford your students a restroom break.
- Programs begin at 9:30 a.m. or 10:00 a.m.
- Afternoon program times are also available.

Cost

- Student - \$8.00.
- Museum memberships do not cover program cost for students.
- Educators & bus drivers - Free (must wear school identification with scheduled programs.)
- Bus drivers must stay on campus and be able to be reached in case of an emergency.
- Parents & chaperones - One free with every 10 students.
- Additional parents & chaperones - \$12.00.
- If a parent or chaperone is a member or active military, you must still check in at the front desk with your card - Free.

Planetarium add-on

- If you have booked a program, planetarium shows may be added for an additional \$2.00 for students and adults including educators, bus drivers and chaperones.
- The Planetarium has 120 seats only. Students have first priority for seating, then educators, then parents.
- Add-on show times begin promptly at the 1:00 p.m. time slot with no late entry and no refund if group arrives late. Shows last 45 minutes.

Chaperones

- Due to space limitations parents may be asked to self-tour the museum during portions of the program rotations.
- Please stress to all of your parents/chaperones that this is a two-hour program dedicated to studying specific Georgia Performance Standards that augment your classroom instruction. It is not a tour of the entire museum.
- Teachers, please indicate who will be your "official" chaperones (one chaperone free with every ten students) and they will receive free admittance. All other adults must pay the \$12.00 admission, unless they are a member.

Deposit

- Reservations are guaranteed only after we receive a \$100 deposit.
- You have ten days to return the form and deposit to Scheduling (if we do not receive both, your program will be cancelled and become available to other groups).

- We accept checks made payable to Tellus Science Museum. We also accept Visa, Master Card, Discover, and American Express.
- Deposits are refundable only if your reservations are cancelled or rescheduled 14 or more days prior to your reservation date.

Museum Store

- The Museum Store is included in the program rotation (please see attached store flyer).

Directions and Parking

- Please see attached bus parking map and share that important information with your driver(s).

Lunch

- Please leave lunches on the bus.
- Outdoor picnic pavilion is available.
- If you would like to purchase box lunches from our café to eat in our pavilion, please call our food and beverage manager at least one week in advance, 770-606-5700. ext. 418.
- **Please Note: The Carter Pavilion is provided as a courtesy to groups for student lunches. As an alternative, an unfurnished room is available for indoor lunches for a \$250.00 non-refundable fee.**

Photography

- Photography for personal use is allowed.
- No flash photography is allowed in the Planetarium, Art Gallery, or on other paintings.

Self Touring

- Schools wishing to visit without booking a school program will follow the Group Visit guidelines to make reservations.
- All adults will pay admission including teachers and bus drivers.
- Start times will be 2:00 p.m. or later.
- [Click here](#) for Group Rates.

Restroom

- For your comfort and convenience the museum has exterior restrooms located by the drop off circle. It will save instructional time if your students could use this restroom upon arrival.

Call 770-606-5699 to schedule!

**We can't wait to share the exciting world of Tellus
with you and your students!**

Jose Santamaria
Executive Director

Cantey Smith
Director of Education

Allison Speer
Science Program Manager

Kerry Cornwell
Geology Program Manager

David Dundee
Astronomy Program Manager

Bus Drop-Off Route

Buses should take the first right into the parking lot and circle around to the drop off point. Bus parking is located at the top of eastern end of the parking lot.

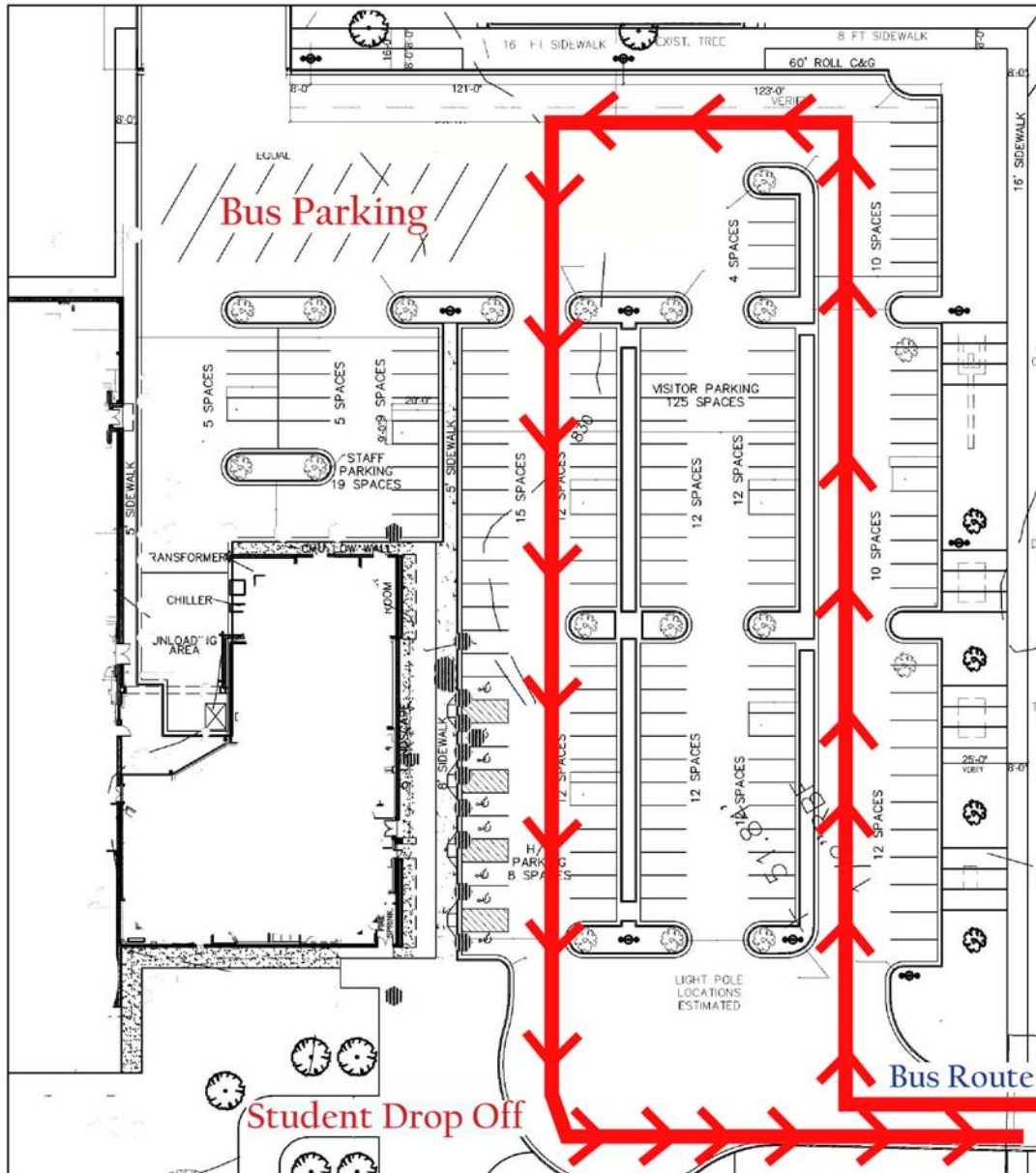



Your child will soon be visiting Tellus Science Museum on a field trip and will have an opportunity to visit the museum's store. If you would like your child to bring home a souvenir from the museum, please be sure he/she has money on the day of the field trip. The store has a variety of science-related merchandise. All store proceeds benefit the educational programs and activities at Tellus. We look forward to your child's visit!

~ Fun Science-Related Merchandise ~

- Gemstone Rings..... \$.93
- Pencils..... \$.25
- Rock Candy..... \$.93
- Arrowheads.....\$.93
- Super Science Tubes.....\$3.00
- Buzz Magnets.....\$3.00
- Rocks/Minerals..... \$.93
- Dinosaur Pinchers.....\$3.99
- Die Cast Cars..... \$7.99
- Mars Mud.....\$3.00
- Much, Much, More.....

